

BRASS CABLE GLAND

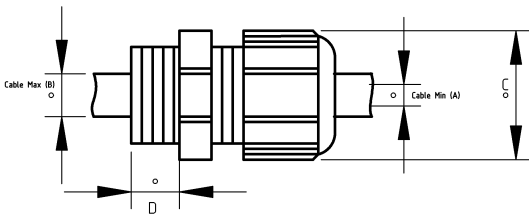

- material : brass
- standard : EN62444 UL514B
- Brass nickel plated core and cover
- Liquid-tight gland for non-armored cables
- Inside : PA6 clamping insert and CR seal
- With NBR O-ring
- High corrosion protection
- High vibration and traction resistance
- With T6400 brass locknut

Technical Details



IP68	-20 C	+100 C
------	-------	--------

Product Code	Size I	A	B	C	D	E	F	Net Weight (kg/pc)	In Pack (pc)
T600207	PG7	3.00	6.00		6.00			0,015	200.00
T600209	PG9	4.00	8.00		6.00			0,019	200.00
T600211	PG11	5.00	10.00		6.00			0,029	100.00
T600212	PG11	6.00	12.00		6.50			0,031	100.00
T600213	PG13.5	6.00	12.00		6.50			0,031	100.00
T600216	PG16	10.00	14.00		6.50			0,041	100.00
T600221	PG21	13.00	18.00		7.20			0,076	50.00
T600229	PG29	18.00	25.00		8.00			0,140	30.00
T600236	PG36	22.00	32.00		9.00			0,272	20.00
T600242	PG42	30.00	38.00		12.00			0,329	12.00
T600248	PG48	34.00	44.00		14.00				
T600411	M12x1.5	2.00	5.00		6.00				
T600412	M12x1.5	3.00	6.50		6.00			0,015	200.00
T600416	M16x1.5	4.00	8.00		7.00			0,023	100.00
T600417	M16x1.5	5.00	10.00		6.50				100.00
T600420	M20x1.5	6.00	12.00		8.00			0,034	100.00
T600421	M20x1.5	10.00	14.00		8.00			0,043	80.00

T600425	M25x1.5	10.00	14.00	8.00			0,049	50.00
T600426	M25x1.5	13.00	18.00	8.00			0,068	60.00
T600432	M32x1.5	13.00	18.00	9.00			0,101	40.00
T600440	M40x1.5	18.00	25.00	9.00			0,180	20.00
T600441	M40x1.5	22.00	32.00	9.00				
T600450	M50x1.5	22.00	32.00	9.00			0,332	10.00
T600451	M50x1.5	27.00	38.00	9.00			0,339	10.00
T600463	M63x1.5	34.00	44.00	14.00			0,481	3.00
T600464	M63x1.5	37.00	53.00	10.00			0,541	8.00
T600475	M75x1.5	56.00	62.00	16.00			0,629	6.00
T600480	M80x1.5	60.00	70.00					
T600490	M90x1.5	60.00	72.00				1,123	4.00
T600810	NPT 1/4"	3.00	6.50	6.00			0,015	200.00
T600813	NPT 3/8"	4.00	8.00	11.50				
T600816	NPT 1/2"	6.00	12.00	13.00			0,033	100.00
T600817	NPT 1/2"	10.00	14.00	13.00				
T600821	NPT 3/4"	13.00	18.00	13.00			0,060	60.00
T600826	NPT 1"	18.00	25.00	13.00				
T600835	NPT 1 1/4"	22.00	32.00	25.60				
T600840	NPT 1 1/2"	30.00	38.00	26.00				
T600852	NPT 2"	34.00	44.00	27.00				