

## CABLE GLAND, STAINLESS STEEL 316L

- Stainless steel (316L) core and cover
- Liquid-tight gland for non-armored cables
- Inside : PA6 clamping insert and CR seal
- With NBR O-ring
- High corrosion protection
- High vibration and traction resistance
- Without locknut



IP68	-20 C	+100 C
------	-------	--------

### Technical Details

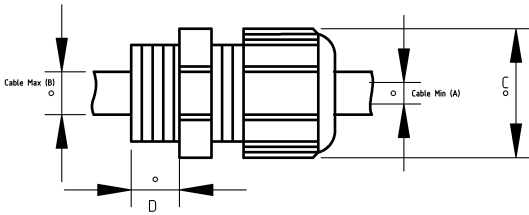

Product Code	Size I	A	B	C	D	E	Net Weight (kg/pc)	In Pack (pc)
T700203	PG7	2.00	5.00					
T700204	PG9	4.00	8.00					
T700205	PG11	5.00	10.00					
T700206	PG13.5	6.00	12.00				0,024	100.00
T700210	PG16	10.00	14.00					
T700213	PG21	13.00	18.00					
T700218	PG29	18.00	25.00					
T700222	PG36	22.00	32.00					
T700230	PG42	30.00	38.00					
T700234	PG48	34.00	44.00					
T700402	M12x1.5	2.00	5.00					
T700403	M12x1.5	3.00	6.50				0,014	300.00
T700404	M16x1.5	4.00	8.00				0,034	100.00
T700406	M20x1.5	6.00	12.00				0,054	100.00
T700407	M20x1.5	10.00	14.00				0,029	100.00
T700410	M25x1.5	10.00	14.00				0,075	50.00
T700411	M25x1.5	13.00	18.00				0,059	50.00

"Your Conduit Partner"

T700413	M32x1.5	13.00	18.00				0,125	30.00
T700418	M40x1.5	18.00	25.00				0,191	20.00
T700422	M50x1.5	22.00	32.00				0,318	12.00
T700434	M63x1.5	34.00	44.00				0,451	8.00
T700804	NPT 3/8"	4.00	8.00					
T700806	NPT 1/2"	6.00	12.00				0,043	100.00
T700812	NPT 3/4"	9.00	16.00					
T700813	NPT 3/4"	13.00	18.00				0,087	40.00
T700818	NPT 1"	18.00	25.00					