

**Aluminum EMT conduits provide reliable cable protection with their lightweight structure and high corrosion resistance. Manufactured using the drawing process, they have no longitudinal welds or burrs, ensuring maximum safety during cable pulling operations.**



- material : aluminum

- Manufactured from high-quality aluminum
- Very lightweight and easy to install
- Provides greater corrosion resistance compared to steel conduits
- Fire resistant – non-combustible, prevents flame spread
- Drawn tube production – no welds, no burrs
- Ensures fast and safe cable pulling
- Lower impact resistance compared to steel, suitable for high-level installations
- Can be cut at any point, but cannot be threaded
- Standard length: 10 feet (3
- 05 m)

#### Technical Details

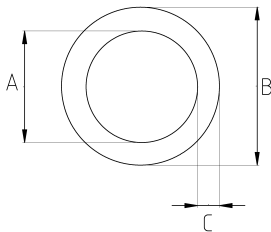

Product Code	Size I	A	B	C	D	E	F	Net Weight (kg/m)	In Pack (m)
RA016	1/2"	16.09	17.93	0.92				0,128	30.50
RA021	3/4"	21.32	23.42	1.05				0,200	30.50
RA026	1"	26.94	29.54	1.31				0,299	30.50