

Infos of RL :



- IP
- MIN
- MAX
- CERT
- RL

Passive Fire Protection No.1

- ▶ Pre-galvanized light steel core
- ▶ Electromagnetic interference screen system
- ▶ Easy carry and montage
- ▶ Mechanical protection
- ▶ EMT interior coating provides a smooth surface for faster wire pulling
- ▶ High grade durable & ductile steel for long life
- ▶ RL model is manufactured 10-feet (3,05 meters) lengths

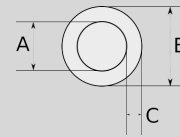

Sizes & Prices :

Product Code	Size	Size	A (mm)	B (mm)	C (mm)	D (mm)	Meters in Pack (m)	Net Weight (kg/m)	Unit Price (USD/m)
RL016	1/2"		16.33	17.82	0.80		30.50	0,325	1,35
RL021	3/4"		21.62	23.40	0.90		30.50	0,546	1,81
RL026	1"		27.54	29.54	1.00		15.25	0,731	2,71
RL035	1 1/4"		37.75	38.40	1.31			0,000	4,51
RL040	1 1/2"		41.61	44.20	1.31			0,000	5,18
RL052	2"		53.02	55.80	1.41		9.00	1,950	7,43

Accessories :

EMT REDUCER



R8700
EMT REDUCER

EMT BOX, OCTAGONAL



R3680
EMT BOX, OCTAGONAL

EMT PIPE CAPS, OPENEND



R7790
EMT PIPE CAPS, OPENEND

EMT SPACER BAR SADDLE



R3840
EMT SPACER BAR SADDLE