

EX-PROOF BARRIER CABLE GLAND FOR ARMoured CABLES

- Brass nickel plated core
- For SWA – SWB – STA – Shielded cable types
- Without T6400 brass locknut
- ATEX II 2GD Ex db IIC Gb ; Ex eb IIC Gb ; Ex tb IIIC Db, IP66/68



IP68	-60 C	+60 C
------	-------	-------

Technical Details

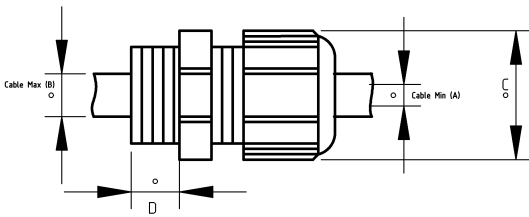

Product Code	Size I	A	B	C	D	E	Net Weight (kg/pc)	In Pack (pc)
V617407	M20x1.5	6.00	13.00	25.00	16.00			
V617408	M20x1.5	8.00	15.00	25.00	16.00			
V617409	M20x1.5	13.50	21.00	30.00	16.00			
V617413	M25x1.5	8.00	15.00	25.00	16.00			
V617414	M25x1.5	13.50	21.00	30.00	16.00			
V617415	M25x1.5	18.00	27.00	40.00	16.00			
V617418	M32x1.5	18.00	27.00	40.00	16.00			
V617419	M32x1.5	23.00	33.00	43.00	16.00			
V617428	M40x1.5	23.00	33.00	43.00	16.00			
V617429	M40x1.5	29.00	40.00	50.00	16.00			
V617434	M50x1.5	29.00	40.00	50.00	20.00			
V617435	M50x1.5	35.00	48.00	58.00	20.00			
V617441	M63x1.5	35.00	48.00	58.00	20.00			
V617442	M63x1.5	42.00	56.00	75.00	20.00			
V617453	M75x1.5	42.00	56.00	75.00	20.00			
V617454	M75x1.5	54.00	70.00	100.00	20.00			
V617469	M90x1.5	54.00	70.00	100.00	20.00			



V6170

EX-PROOF BARRIER CABLE GLAND FOR ARMoured CABLES

"Your Conduit Partner"

V617807	NPT 1/2"	6.00	13.00	25.00	21.00
---------	----------	------	-------	-------	-------