

## EX-PROOF BRASS CABLE GLAND CLASS E

- Brass nickel plated core
- For non-armoured cables
- Seal Material : Chloroprene
- Without T6400 brass locknut
- IP68 – 5 Bar, 30 min
- EX II 2GD Ex db IIC Gb



|      |       |       |
|------|-------|-------|
| IP68 | -40 C | +80 C |
|------|-------|-------|

### Technical Details

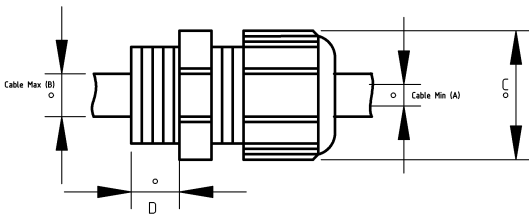

| Product Code | Size I  | A     | B     | C | D | E | Net Weight (kg/pc) | In Pack (pc) |
|--------------|---------|-------|-------|---|---|---|--------------------|--------------|
| V600402      | M12x1.5 | 3.00  | 8.00  |   |   |   | 0,049              | 80.00        |
| V600403      | M16x1.5 | 3.00  | 9.00  |   |   |   | 0,048              | 80.00        |
| V600404      | M16x1.5 | 4.00  | 12.00 |   |   |   | 0,048              | 80.00        |
| V600405      | M20x1.5 | 3.00  | 9.00  |   |   |   | 0,053              | 60.00        |
| V600406      | M20x1.5 | 4.00  | 12.00 |   |   |   | 0,048              | 80.00        |
| V600407      | M20x1.5 | 10.00 | 16.00 |   |   |   | 0,069              | 50.00        |
| V600409      | M25x1.5 | 4.00  | 12.00 |   |   |   | 0,070              | 60.00        |
| V600410      | M25x1.5 | 10.00 | 18.00 |   |   |   | 0,071              | 40.00        |
| V600411      | M25x1.5 | 14.00 | 20.00 |   |   |   | 0,116              | 30.00        |
| V600414      | M32x1.5 | 14.00 | 24.00 |   |   |   | 0,116              | 25.00        |
| V600415      | M32x1.5 | 22.00 | 28.00 |   |   |   | 0,195              | 20.00        |
| V600421      | M40x1.5 | 14.00 | 24.00 |   |   |   |                    |              |
| V600422      | M40x1.5 | 22.00 | 32.00 |   |   |   | 0,202              | 20.00        |
| V600423      | M40x1.5 | 26.00 | 34.00 |   |   |   | 0,283              | 16.00        |
| V600426      | M50x1.5 | 26.00 | 35.00 |   |   |   |                    |              |
| V600435      | M63x1.5 | 35.00 | 45.00 |   |   |   | 0,468              | 6.00         |
| V600446      | M75x1.5 | 46.00 | 62.00 |   |   |   |                    |              |

|         |            |       |       |  |  |  |       |  |        |
|---------|------------|-------|-------|--|--|--|-------|--|--------|
| V600460 | M90x1.5    | 60.00 | 75.00 |  |  |  |       |  |        |
| V600461 | M90x1.5    | 75.00 | 82.00 |  |  |  |       |  |        |
| V600803 | NPT 3/8"   | 3.00  | 9.00  |  |  |  |       |  |        |
| V600805 | NPT 1/2"   | 3.00  | 9.00  |  |  |  |       |  |        |
| V600806 | NPT 1/2"   | 4.00  | 12.00 |  |  |  | 0,048 |  | 100.00 |
| V600809 | NPT 3/4"   | 4.00  | 12.00 |  |  |  | 0,073 |  | 40.00  |
| V600810 | NPT 3/4"   | 10.00 | 18.00 |  |  |  | 0,081 |  | 40.00  |
| V600811 | NPT 3/4"   | 14.00 | 20.00 |  |  |  |       |  |        |
| V600814 | NPT 1"     | 14.00 | 24.00 |  |  |  | 0,135 |  | 20.00  |
| V600822 | NPT 1 1/4" | 22.00 | 32.00 |  |  |  | 0,232 |  | 16.00  |
| V600826 | NPT 1 1/2" | 26.00 | 35.00 |  |  |  | 0,341 |  | 10.00  |
| V600835 | NPT 2"     | 35.00 | 45.00 |  |  |  | 0,488 |  | 8.00   |