

## EX-PROOF CABLE GLAND, STAINLESS STEEL 316L

- Stainless steel 316L core
- For SWA – SWB – STA – PWA – AWA – Shielded cable types
- Without T7400 stainless steel locknut
- ATEX II 2GD Ex db IIC Gb ; Ex eb IIC Gb ; Ex tb IIIC Db, IP66/68



IP68	-40 C	+100 C
------	-------	--------

### Technical Details

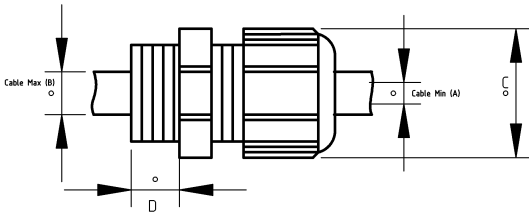

Product Code	Size I	A	B	C	D	E	Net Weight (kg/pc)	In Pack (pc)
V710403	M12x1.5	3.00	5.50	2.00	4.00			
V710405	M16x1.5	8.50	16.00	6.00	12.00			
V710409	M20x1.5	8.50	16.00	6.00	12.00			
V710412	M25x1.5	12.00	21.00	8.50	16.00			
V710420	M32x1.5	20.00	33.00	15.00	26.00			
V710429	M40x1.5	29.00	41.00	20.00	32.00			
V710436	M50x1.5	36.00	52.00	27.00	41.00			
V710447	M63x1.5	47.00	60.00	40.00	52.00			
V710454	M75x1.5	54.00	70.00	45.00	60.00			
V710809	NPT 1/2"	8.50	16.00	6.00	12.00			
V710812	NPT 3/4"	12.00	21.00	8.50	16.00			
V710820	NPT 1"	20.00	33.00	15.00	26.00			