

EX-PROOF BRASS CABLE GLAND FOR SWA AWA CABLES

- Brass nickel plated core
- For SWA – SWB – STA – PWA – AWA – Shielded cable types
- Without T6400 brass locknut
- ATEX II 2GD Ex db IIC Gb ; Ex eb IIC Gb ; Ex tb IIIC Db, IP66/68



IP68	-40 C	+100 C
------	-------	--------

Technical Details

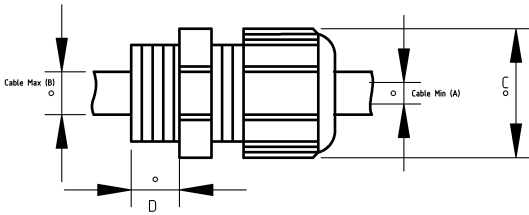

Product Code	Size I	A	B	C	D	E	Net Weight (kg/pc)	In Pack (pc)
V610403	M12x1.5	3.00	5.50	2.00	4.00			
V610404	M16x1.5	6.00	12.00	3.00	8.50			
V610405	M16x1.5	8.50	16.00	6.00	12.00			
V610408	M20x1.5	6.00	12.00	3.00	8.50		0,119	30.00
V610409	M20x1.5	8.50	16.00	6.00	12.00		0,126	25.00
V610410	M20x1.5	12.00	20.00	8.50	14.50		0,138	20.00
V610411	M25x1.5	8.50	16.00	6.00	12.00			
V610412	M25x1.5	12.00	21.00	8.50	16.00		0,194	20.00
V610413	M25x1.5	16.00	26.00	12.00	20.00		0,243	16.00
V610420	M32x1.5	20.00	33.00	15.00	26.00		0,547	8.00
V610428	M40x1.5	20.00	33.00	15.00	26.00			
V610429	M40x1.5	29.00	41.00	20.00	32.00		0,752	5.00
V610435	M50x1.5	33.00	48.00	22.00	35.00			
V610436	M50x1.5	36.00	52.00	27.00	41.00		1,187	3.00
V610447	M63x1.5	47.00	60.00	40.00	52.00		1,720	2.00
V610448	M63x1.5	54.00	70.00	45.00	56.00			
V610474	M75x1.5	47.00	60.00	40.00	52.00			

"Your Conduit Partner"

V610475	M75x1.5	54.00	70.00	45.00	56.00			
V610806	NPT 3/8"	6.00	12.00	3.00	8.50			
V610808	NPT 1/2"	6.00	12.00	3.00	8.50	0,129		40.00
V610809	NPT 1/2"	8.50	16.00	6.00	12.00			
V610810	NPT 1/2"	12.00	20.00	8.50	14.50			
V610811	NPT 3/4"	8.50	16.00	6.00	12.00			
V610812	NPT 3/4"	12.00	21.00	8.50	16.00	0,206		20.00
V610813	NPT 3/4"	16.00	26.00	12.00	20.00			
V610820	NPT 1"	20.00	33.00	15.00	26.00			
V610828	NPT 1 1/4"	20.00	33.00	15.00	26.00			
V610829	NPT 1 1/4"	29.00	41.00	20.00	32.00			
V610833	NPT 1 1/2"	33.00	48.00	22.00	35.00			
V610836	NPT 1 1/2"	36.00	52.00	27.00	41.00			
V610847	NPT 2"	47.00	60.00	40.00	52.00			
V610854	NPT 2 1/2"	54.00	70.00	45.00	60.00			
V610863	NPT 3"	63.00	80.00	60.00	72.00			
V610888	NPT 3 1/2"	63.00	80.00	60.00	72.00			