

Infos of SL :



- IP50
- MIN
- MAX
- CERT
- SL

FLEXIBLE CONDUIT, STAINLESS STEEL

- ▶ Stainless steel core (AISI304)
- ▶ Extremely small bending radius
- ▶ High flexibility
- ▶ Non liquid - tight

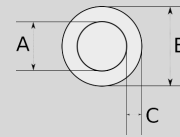

Sizes & Prices :

Product Code	Size	Size	A (mm)	B (mm)	C (mm)	D (mm)	Meters in Pack (m)	Net Weight (kg/m)	Unit Price (USD/m)
SL010	1/4"		10.00	13.50	1.75	25.00	50.00	0,096	4,72
SL013	3/8"		12.50	16.00	1.75	33.00	50.00	0,103	5,15
SL016	1/2"		16.00	19.50	1.75	38.00	50.00	0,163	6,67
SL021	3/4"		20.50	25.00	2.25	45.00	50.00	0,179	8,41
SL026	1"		26.50	30.50	2.25	55.00	50.00	0,269	11,17
SL035	1 1/4"		35.00	40.00	2.50	62.00	30.00	0,395	15,94
SL040	1 1/2"		40.00	45.00	2.50	90.00	30.00	0,401	18,25
SL052	2"		51.50	56.50	2.50	110.00	20.00	0,637	22,37
SL063	2 1/2"		63.00	70.50	3.75	130.00	10.00	1,025	48,04
SL078	3"		78.00	85.50	3.75	160.00	10.00	1,231	56,11
SL102	4"		102.00	109.00	3.75	210.00	5.00	1,736	72,68

Accessories :

LIQUID-TIGHT CONNECTOR, STAINLESS STEEL 90



S7900

LIQUID-TIGHT CONNECTOR, STAINLESS STEEL 91

PLIABLE STAINLESS STEEL CONDUIT, TUBE



SPC

PLIABLE STAINLESS STEEL CONDUIT, TUBE

FLEXIBLE CONDUIT, STAINLESS STEEL



SL

FLEXIBLE CONDUIT, STAINLESS STEEL

STAINLESS STEEL FLEXIBLE TUBE



SWT

STAINLESS STEEL FLEXIBLE TUBE