

Infos of SLA :

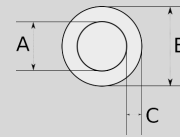

- ☁
- IP
- MIN
- 40
- MAX
- 150
- CERT
- SLA

**FLEXIBLE STAINLESS CONDUIT, HIGH TEMP, STAINLESS BRAIDED**



Sizes & Prices :

Product Code	Size	Size	A (mm)	B (mm)	C (mm)	D (mm)	Meters in Pack (m)	Net Weight (kg/m)	Unit Price (USD/m)
SLA008	5/16"		8.00	13.00			50.00	0,000	12,80
SLA010	1/4"		10.00	15.00			50.00	0,000	15,51
SLA013	3/8"		12.50	18.00			50.00	0,283	17,45
SLA016	1/2"		16.00	22.00			50.00	0,372	21,51
SLA021	3/4"		20.50	27.00			50.00	0,000	27,28
SLA026	1"		26.50	34.00			50.00	0,000	33,94
SLA035	1 1/4"		35.00	43.00			30.00	0,000	45,48
SLA040	1 1/2"		40.00	49.00			30.00	0,000	51,82
SLA052	2"		51.50	60.00			20.00	0,000	63,92
SLA063	2 1/2"		63.00	76.00			10.00	0,000	97,21
SLA078	3"		78.00	91.00			10.00	0,000	115,87
SLA102	4"		102.00	113.00			5.00	0,000	151,22

Accessories :

<p>FLEXIBLE STEEL CONDUIT WIRE BRAIDED</p> <p><b>BNX</b></p> <p>FLEXIBLE STEEL CONDUIT WIRE BRAIDED</p>	<p>FLEXIBLE STEEL CONDUIT HIGH TEMP, STAINLESS BRAIDED</p> <p><b>BNTX</b></p> <p>FLEXIBLE STEEL CONDUIT HIGH TEMP, STAINLESS BRAIDED</p>	<p>FLEXIBLE CONDUIT, LIQUID-TIGHT STAINLESS BRAIDED</p> <p><b>LTX</b></p> <p>FLEXIBLE CONDUIT, LIQUID-TIGHT STAINLESS BRAIDED</p>	<p>FLEXIBLE STEEL CONDUIT UL LISTED</p> <p><b>BD</b></p> <p>FLEXIBLE STEEL CONDUIT UL LISTED</p>
---	--	---	--