

RIGID AND IMC CONDUIT BODY LL

- Aluminum body, steel cover and gasket
- Type LL
- Aluminum bodies with epoxy powder coat
- Neoprene gaskets
- For use with threaded Rigid/IMC conduit, for inspection, pulling and maintenance
- UL Listed
- Color : Gray

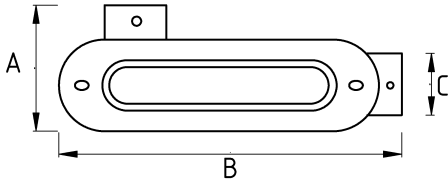

Technical Details



Product Code	Size I	A	B	C	D	E	Net Weight (kg/pc)	In Pack (pc)
N470616	1/2"	51.00	109.00	27.00			0,137	12.00
N470621	3/4"	59.00	129.00	34.50			0,208	10.00
N470626	1"	60.40	150.00	41.50			0,285	6.00
N470635	1 1/4"	89.00	200.00	50.50			0,541	3.00
N470640	1 1/2"	85.00	200.00	55.50			0,543	18.00
N470652	2"						1,031	8.00
N470663	2 1/2"							
N470678	3"							
N470702	4"							