

## RIGID AND IMC CONDUIT BODY LR

- Aluminum body, steel cover and gasket
- Type LR
- Aluminum bodies with epoxy powder coat
- Neoprene gaskets
- For use with threaded Rigid/IMC conduit, for inspection, pulling and maintenance
- UL Listed
- Color : Gray

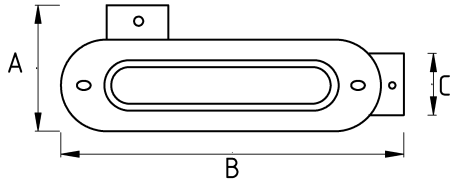

### Technical Details



Product Code	Size I	A	B	C	D	E	Net Weight (kg/pc)	In Pack (pc)
N472616	1/2"						0,126	16.00
N472621	3/4"						0,195	10.00
N472626	1"						0,215	6.00
N472635	1 1/4"						0,529	3.00
N472640	1 1/2"						0,481	18.00
N472652	2"						0,922	8.00
N472663	2 1/2"							
N472678	3"						1,941	2.00
N472702	4"							