

## BRASS CABLE GLAND EN45545

- Brass nickel plated core and cover
- Liquid-tight gland for non-armored cables
- Inside : PA6 clamping insert and EPDM seal
- With EPDM O-ring
- High corrosion protection
- High vibration and traction resistance
- Complies with EN45545-2 standard
- Without T6400 brass locknut



IP68	-40 C	+100 C
------	-------	--------

### Technical Details

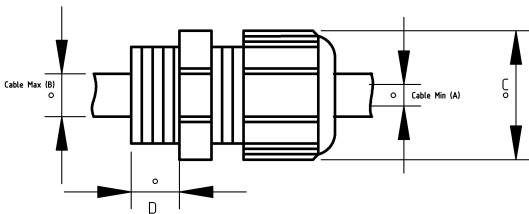

Product Code	Size I	A	B	C	D	E	Net Weight (kg/pc)	In Pack (pc)
T605403	M12x1.5	3.00	6.50		6.00			
T605404	M16x1.5	4.00	8.00		7.00			
T605406	M20x1.5	6.00	12.00		8.00			
T605407	M20x1.5	10.00	14.00		8.00			
T605410	M25x1.5	13.00	18.00		8.00			
T605415	M32x1.5	18.00	25.00		9.00			
T605421	M40x1.5	22.00	32.00		9.00			