

Infos of RC :



- ☁
- IP
- MIN
- MAX
- CERT
- RC

Passive Fire Protection No.1

- ▶ Hot-dip galvanized steel core
- ▶ Electromagnetic interference screen system
- ▶ Easy carry and montage
- ▶ Mechanical protection
- ▶ EMT interior coating provides a smooth surface for faster wire pulling
- ▶ High grade durable & ductile steel for long life
- ▶ HDG EMT is manufactured 10-feet (3,05 meters) lengths
- ▶ UL Listed

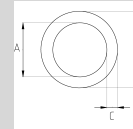

Sizes & Prices :

Product Code	Size	Size	A (mm)	B (mm)	C (mm)	D (mm)	Meters in Pack (M)	Net Weight (kg/M)
RC016	1/2"		15.80	17.90	1.07		30.50	0,420
RC021	3/4"		20.90	23.40	1.25		30.50	0,650
RC026	1"		26.60	29.50	1.45		15.25	0,950
RC035	1 1/4"		35.10	38.40	1.65		15.25	1,410
RC040	1 1/2"		40.90	44.20	1.65		15.25	1,640
RC052	2"		51.90	55.80	1.65		9.15	2,080
RC063	2 1/2"		69.40	73.00	1.83			3,210
RC078	3"		85.20	88.90	1.83			3,910
RC102	4"		110.10	114.30	2.11			5,850

Accessories :

EMT COMPRESSION CONNECTOR 90



R3900

EMT COMPRESSION CONNECTOR 90

EMT SET SCREW COUPLING



R3550

EMT SET SCREW COUPLING

EMT TO FLEX. COMBINATION COUPLING



R3400

EMT TO FLEX. COMBINATION COUPLING

EMT BOX, SQUARE



R3640

EMT BOX, SQUARE