

Infos of RE :

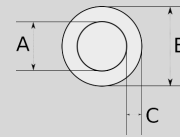

- Passive Fire Protection No.1**
- IP**
- MIN**
- MAX**
- CERT**
- RE**

- ▶ Pre-galvanized steel core
- ▶ Electromagnetic interference screen system
- ▶ Easy carry and montage
- ▶ Mechanical protection
- ▶ EMT interior coating provides a smooth surface for faster wire pulling
- ▶ High grade durable & ductile steel for long life
- ▶ RE model is manufactured 3 meters lengths



Sizes & Prices :

Product Code	Size	Size	A (mm)	B (mm)	C (mm)	D (mm)	Meters in Pack (m)	Net Weight (kg/m)	Export Price (USD/m)
RE016	1/2"		15.80	17.90	1.07		60.00	0,420	1,68
RE021	3/4"		20.90	23.40	1.25		30.00	0,650	2,64
RE026	1"		26.60	29.50	1.45		30.00	0,963	3,84
RE035	1 1/4"		35.10	38.40	1.65		15.00	1,410	5,99
RE040	1 1/2"		40.90	44.20	1.65		15.00	1,640	6,96
RE052	2"		51.90	55.80	1.65		9.00	2,080	8,88
RE063	2 1/2"		69.40	73.00	1.83			3,210	14,41
RE078	3"		85.20	88.90	1.83			3,910	17,99
RE102	4"		110.10	114.30	2.11			5,850	27,36

Accessories :

EMT COUPLING, STEEL, SET SCREW



R4550

EMT COUPLING, STEEL, SET SCREW

EMT ANGLE 45



R4400

EMT ANGLE 45

EMT PULL ELBOW WITH GASKET 90



R3970

EMT PULL ELBOW WITH GASKET 90

EMT CONNECTOR, COMPRESSION 90



R3900

EMT CONNECTOR, COMPRESSION 90