

Infos of LD :

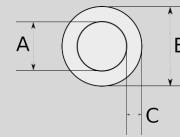

- IP68
- MIN -50
- MAX 105
- CERT
- LD

FLEXIBLE CONDUIT, STEEL, LIQUID-TIGHT BLACK UL LISTED



Sizes & Prices :

Product Code	Size	Size	A (mm)	B (mm)	C (mm)	D (mm)	Meters in Pack (M)	Net Weight (kg/M)	Export Price (USD/M)
LD013	3/8"		13.00	18.00	2.50	50.50	30.00	0,000	8,46
LD016	1/2"		16.00	21.00	2.50	82.50	30.00	0,000	9,93
LD021	3/4"		21.00	26.00	2.50	108.00	30.00	0,000	12,72
LD026	1"		26.00	34.00	4.00	165.00	20.00	0,000	21,36
LD035	1 1/4"		35.00	42.00	3.50	203.00	20.00	0,000	28,98
LD040	1 1/2"		40.00	48.00	4.00	228.50	20.00	0,000	34,56
LD052	2"		52.00	60.00	4.00	282.50	15.00	0,000	43,26
LD063	2 1/2"		63.00	73.00	5.00	374.50	10.00	0,000	119,39
LD078	3"		78.00	89.00	5.50	444.50	10.00	0,000	158,91
LD102	4"		102.00	114.00	6.00	609.50	5.00	0,000	229,29

Accessories :

CONNECTOR, ALUMINUM, LIQUID-TIGHT SWIVEL



L2030

CONNECTOR, ALUMINUM, LIQUID-TIGHT SWIVEL

FLEXIBLE CONDUIT, LIQUID-TIGHT UV RESISTANT



LTR

FLEXIBLE CONDUIT, LIQUID-TIGHT UV RESISTANT

CONNECTOR, METALLIC, LIQUID-TIGHT, UL MALE



L4000

CONNECTOR, METALLIC, LIQUID-TIGHT, UL MALE

CONNECTOR, METALLIC, LIQUID-TIGHT 90



L3900

CONNECTOR, METALLIC, LIQUID-TIGHT 90