



Infos of L3000 :

| |
|---|
|  |
| IP68 |
| MIN  |
| -25 |
| MAX  |
| 70 |
| CERT |
| L3000 |

Çizilmeyen oksitlenmeyen rakor!

- Çinko - alüminyum alaşımı
- Galvaniz kaplamalı
- Harici tip
- Yağlara, dış hava şartlarına dayanıklı
- BF, BS, BN model çelik spiral borularla kullanıldığında IP50
- LT model çelik spiral boru ile kullanıldığında IP67
- Çelik somunu ile beraber
- Pano giriş - erkek tip

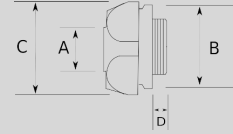
Sizes & Prices :

| Ürün Kodu | Ölçü | Ölçü | A (mm) | B (mm) | C (mm) | D (mm) | Paket Miktarı (ad) | Net Ağırlık (kg/ad) | Satış Fiyatı (USD/ad) |
|-----------|---------|------|--------|--------|--------|--------|--------------------|---------------------|-----------------------|
| L300210 | PG9 | | 10.00 | | | | 100.00 | 0,029 | 1,35 |
| L300211 | PG11 | | 10.00 | | | | 100.00 | 0,031 | 1,58 |
| L300213 | PG11 | | 13.00 | | | | 100.00 | 0,039 | 1,58 |
| L300214 | PG13.5 | | 13.00 | | | | 100.00 | 0,040 | 1,81 |
| L300215 | PG13.5 | | 16.00 | | | | 60.00 | 0,052 | 1,81 |
| L300216 | PG16 | | 16.00 | | | | 60.00 | 0,058 | 2,03 |
| L300221 | PG21 | | 21.00 | | | | 60.00 | 0,075 | 2,48 |
| L300226 | PG29 | | 26.00 | | | | 30.00 | 0,116 | 3,61 |
| L300235 | PG36 | | 35.00 | | | | | 0,000 | 6,75 |
| L300240 | PG42 | | 40.00 | | | | | 0,000 | 7,65 |
| L300252 | PG48 | | 52.00 | | | | | 0,000 | 12,38 |
| L300410 | M16x1.5 | | 10.00 | | | | 100.00 | 0,036 | 1,35 |
| L300412 | M16x1.5 | | 13.00 | | | | 100.00 | 0,036 | 1,35 |
| L300413 | M20x1.5 | | 13.00 | | | | 100.00 | 0,036 | 1,81 |
| L300416 | M20x1.5 | | 16.00 | | | | 60.00 | 0,051 | 1,81 |
| L300421 | M25x1.5 | | 21.00 | | | | 60.00 | 0,080 | 2,48 |
| L300426 | M32x1.5 | | 26.00 | | | | 30.00 | 0,109 | 3,61 |
| L300435 | M40x1.5 | | 35.00 | | | | 20.00 | 0,170 | 6,75 |
| L300440 | M50x1.5 | | 40.00 | | | | 10.00 | 0,251 | 7,88 |
| L300452 | M63x1.5 | | 52.00 | | | | 8.00 | 0,292 | 12,38 |
| L300463 | M75x1.5 | | 63.00 | | | | 6.00 | 0,000 | 21,15 |
| L300478 | M80x1.5 | | 78.00 | | | | 4.00 | 0,000 | 29,25 |
| L300502 | M90x1.5 | | 102.00 | | | | | 0,000 | 46,58 |
| L300610 | 1/4" | | 10.00 | | | | 100.00 | 0,022 | 1,05 |
| L300613 | 1/2" | | 13.00 | | | | 100.00 | 0,035 | 1,05 |
| L300616 | 1/2" | | 16.00 | | | | 100.00 | 0,040 | 1,21 |
| L300621 | 3/4" | | 21.00 | | | | 50.00 | 0,059 | 1,62 |
| L300626 | 1" | | 26.00 | | | | 25.00 | 0,102 | 2,11 |
| L300635 | 1 1/4" | | 35.00 | | | | 20.00 | 0,155 | 3,75 |
| L300640 | 1 1/2" | | 40.00 | | | | 15.00 | 0,209 | 5,64 |
| L300652 | 2" | | 52.00 | | | | 8.00 | 0,334 | 7,62 |
| L300663 | 2 1/2" | | 63.00 | | | | 6.00 | 0,571 | 14,85 |
| L300678 | 3" | | 78.00 | | | | 4.00 | 0,760 | 18,15 |
| L300702 | 4" | | 102.00 | | | | 1.00 | 1,242 | 27,54 |

| | | | | | |
|---------|----|--------|------|-------|--------|
| L300725 | 5" | 125.00 | 1.00 | 2,680 | 86,02 |
| L300750 | 6" | 150.00 | 1.00 | 4,040 | 121,81 |

Accessories :

ÇELİK SİRAL RAKORU, HARİCİ UL DİŞİ

**L4200**

UL sertifikalı çelik dişi rakor!

PİRİNÇ SİRAL RAKORU, HARİCİ ERKEK

**L6000**

Pirinç üzeri nikel kaplı rakor – IP67

ÇELİK SİRAL RAKORU, HARİCİ UL 45

**L4400**

Kaplama kalitesi.

GALVANİZ SİRAL RAKORU, HARİCİ 45

**L3400**

Çizilmeyen oksitlenmeyen 45° dirsek!