

RIGID AND IMC CONDUIT BODY LB

- Aluminum body, steel cover and gasket
- Type LB
- Aluminum bodies with epoxy powder coat
- Neoprene gaskets
- For use with threaded Rigid/IMC conduit, for inspection, pulling and maintenance
- UL Listed
- Color : Gray

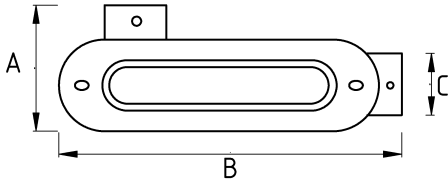

Технические характеристики



Код продукта	Размер I	A	B	C	D	E	Вес нетто (кг/шт)	Количество в
N478616	1/2"						0,122	20.00
N478621	3/4"						0,202	10.00
N478626	1"						0,224	8.00
N478635	1 1/4"						0,486	6.00
N478640	1 1/2"						0,495	3.00
N478652	2"						0,996	8.00
N478663	2 1/2"							
N478678	3"						2,305	2.00
N478702	4"							